



Note:  
Do not scale from this drawing.  
Dimensions are to be checked on site.  
If in doubt please ask.



**Notes**  
(To be read in conjunction with the Structural Engineers Report)

- Water tank and pipes to be reinstated
- Windows and Doors to be replaced like for like
- All vegetation growth & debris to be removed
- Corrugated sheeting to be applied to external wall
- Remove asbestos wall sheeting and replace with robust timber boarding.
- Rebuild existing Lean-to
- Area of wall to be rebuilt
- Area of wall to be repointed
- Demolition
- Gantry to be removed, restored and replaced
- Area of floor to be removed and replaced

Refer to drawings (05) 001 - 004 for elevation repairs

C	04/12/17	Revised to client comments
B	22/11/17	Revised to client comments
A	02/11/17	Incorporating structural engineers comments

**Rev Date/Intls Details**

© The moral rights of the author are hereby asserted.  
This drawing and design is the sole property of Buttress Ltd and must not be reproduced without permission.  
Buttress Ltd is Registered in England and Wales. 3363573

# Buttress

41 Bengal St  
Manchester  
M4 6AF

T 0161 236 3303  
E contact@buttress.net  
W www.buttress.net

**Project Title** Murgatroyd's Brine Pump (Stage 2)  
**Client** Middlewich Town Council  
**Location** Middlewich

**Drawing Title** Proposed  
Floor Plan

**Date** 20.09.17 **Scale** 1:50  
**Checked** DTS **Orig Paper Size** A3

**Status** PRELIMINARY

Drawing ref	Job No	Drawing No	Revision
	8402	(04) 001	C

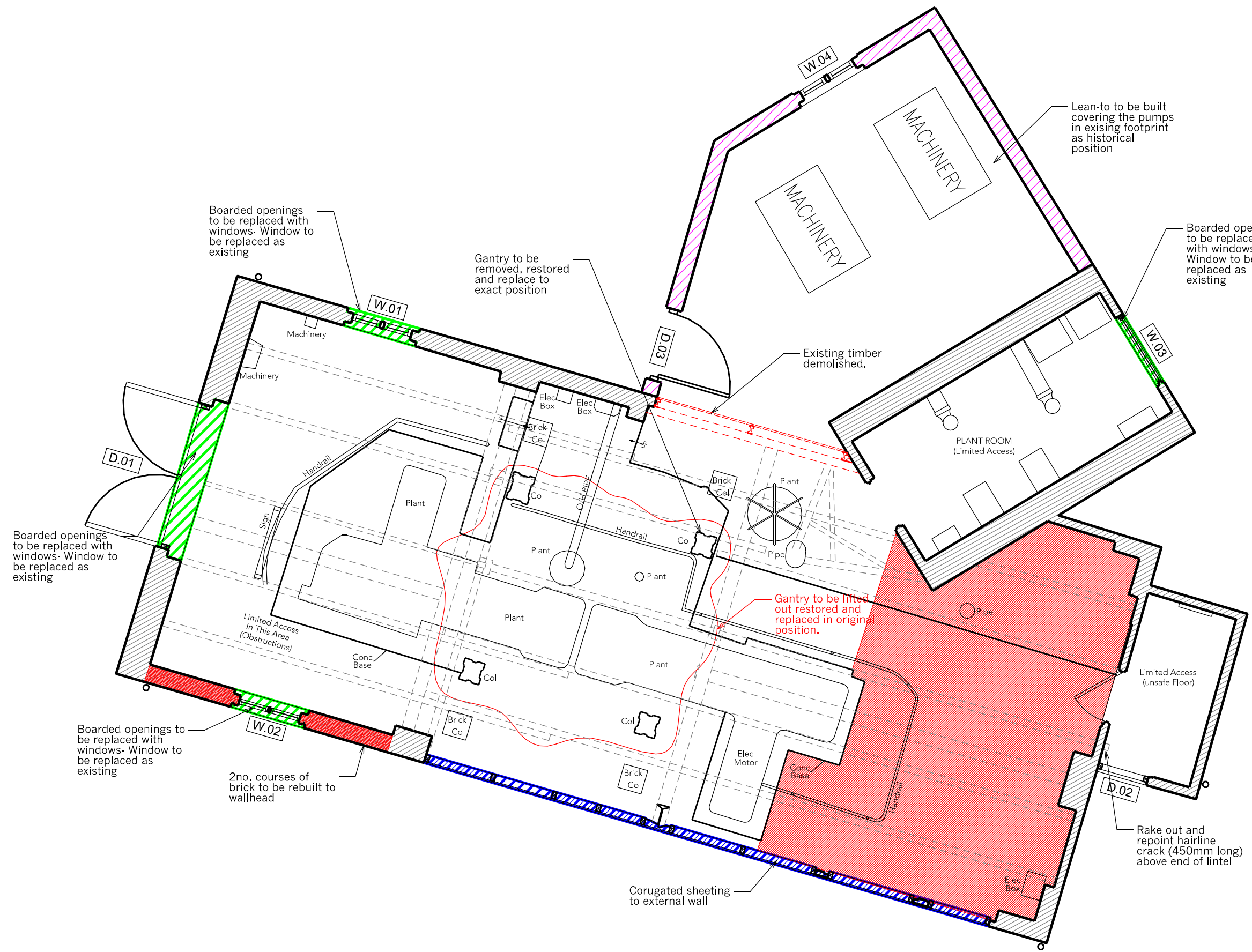

Boarded openings to be replaced with windows- Window to be replaced as existing

Gantry to be removed, restored and replace to exact position

Lean-to to be built covering the pumps in existing footprint as historical position

Boarded openings to be replaced with windows- Window to be replaced as existing

Existing timber demolished.

Boarded openings to be replaced with windows- Window to be replaced as existing

Gantry to be lifted out restored and replaced in original position.

Boarded openings to be replaced with windows- Window to be replaced as existing

2no. courses of brick to be rebuilt to wallhead

Rake out and repoint hairline crack (450mm long) above end of lintel

Corrugated sheeting to external wall